

TECHNICAL DATA SHEET No. 3

Reece Safety Products Ltd

Unit B9, Lowfields Close, Lowfields Business Park, Elland, West Yorkshire HX5 9DX

Tel: 01422 310456 Fax: 01422 311070 Email sales@reecesafety.co.uk www.reecesafety.co.uk



Product Information and Assembly Instructions - Ball Valve Lockouts BS01/02/03



DESCRIPTION

Design

Features

Material

Flash Point

Dielectric Constant

Process

Colour

UV Protection

Ball valve lockout, Models BS01 & BS02 allow valves to be locked in either the open or closed positions. Model BS03 locks closed only
Fully dielectric, good low-temperature resistance
Intermediate-Impact Polypropylene Copolymer
330 deg. C
2.3 to 2.4
Injection molding
Available in Red, Yellow, Blue and Green
Provided by the colour added to the base resin



DIMENSIONS

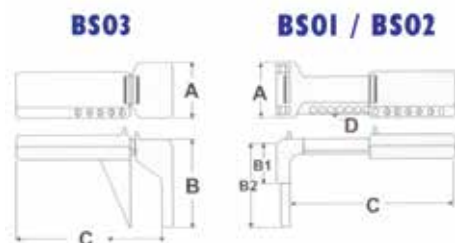

Models	Width A	Height B	Length of Handle C	Lock Hole D
BS01	3.100" 80 mm.	3.250" 82 mm.	5.375" to 7.500" 135 mm. to 190 mm.	0.312" dia. 8 mm.
BS02	3.750" 95 mm.	5.000" 125 mm.	7.500" to 10.000" 190 mm. to 250 mm.	0.312" dia. 8 mm.
BS03	4.000" 100 mm.	7.450" 186 mm.	12.000" to 17.500" 300 mm to 438 mm	0.312" dia. 8 mm.

CHEMICAL RESISTANCE

Polypropylene like most of the polyolefins, is highly resistant to solvents, chemicals and most strong mineral acids and bases but it is subject to attack by oxidizing agents such as chlorosulfonic acids, oleum, sulfuric acid, hydrogen peroxide (at 210 F), sulfuric acid (at 140 F), fuming nitric acid, liquid bromine, etc. With a few exceptions, however, inorganic chemicals produce little or no effect on our products over a period of 6 months at temperatures up to 250 F. When the product is removed from an organic chemicals environment such as benzene, carbon tetrachloride, petroleum, ethanol, acetone, etc. evaporation will take place and changes resulting from the absorption will be reversed if evaporation is complete.

USEFUL SERVICE LIFE

The useful service life expectancy is 4 years and is limited by the nature of the environment.

ASSEMBLY INSTRUCTIONS

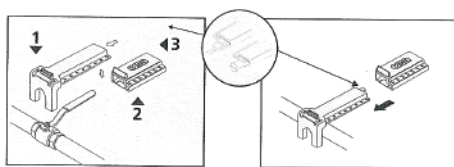

BS01 ASSEMBLY INSTRUCTIONS

- PARTS**
- 1 VALVE HANDLE COVER
 - 2 MULTIPLE LOCKOUT SLIDING PIECE
 - 3 SLIDING ADJUSTMENT PIECE

INSTALLATION

Cover valve handle with part 1.
For maximum adjustment insert piece 3 either recto or verso depending on the thickness of valve handle.
Slide part 2 over part 1.
Align holes and install your lock.

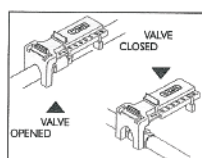

BS03 ASSEMBLY INSTRUCTIONS

- PARTS**
- 1 VALVE HANDLE COVER
 - 2 MULTIPLE LOCKOUT SLIDING PIECE

INSTALLATION

Cover valve with part 1.
Slide part 2 over part 1.
Align holes and install your lock.
N/B The valve cannot be locked in the open position with the BS03

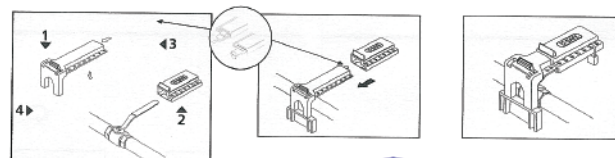

BS02 ASSEMBLY INSTRUCTIONS

- PARTS**
- 1 VALVE HANDLE COVER
 - 2 MULTIPLE LOCKOUT SLIDING PIECE
 - 3 SLIDING ADJUSTMENT PIECE
 - 4 FRONT EXTENSION

INSTALLATION

Cover valve handle with part 1. If need be (for larger ball valves 2" 3") slide part 4 into front of part 1. For maximum adjustment, insert part 3 either recto or verso depending on the thickness of the valve handle. Slide part 2 over part 1. Align holes and install your lock.

