

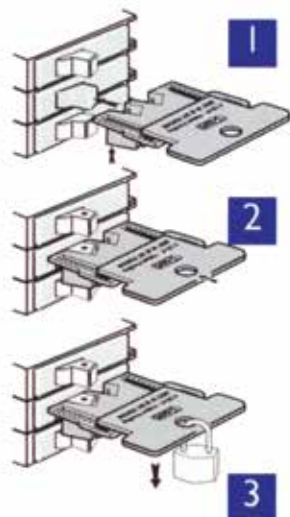

Product Information and Assembly Instructions - Intermediate Circuit Breaker Lockout Kit ECBKIT (Sheet 1)

ASSEMBLY INSTRUCTIONS

CB01



CB02

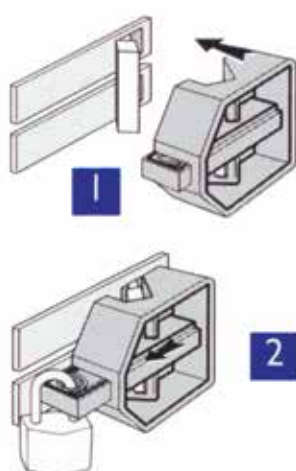

CB03

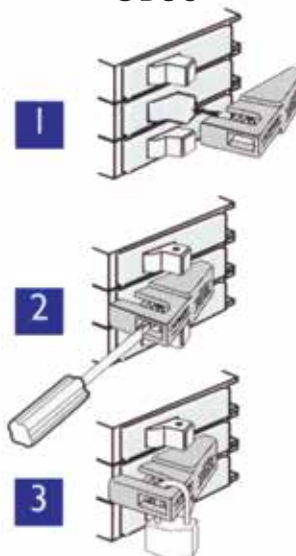

CB04

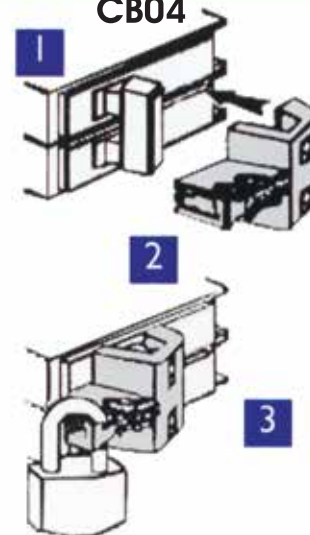

CB01

Our single pole breaker lockout requires a single switch with a recess hole in it.

1 To install, simply open the lock by sliding the base of the lock backwards.

2 Place over the switch, making sure that the small pole inside the lockout device is now inserted into the hole of the switch. Close the lockout by pushing the base forward after ensuring that the holes are aligned.

3 You are now ready to install your padlock.

This model will accommodate breakers upto 12.5mm (1/2") in width.

Remember, the breaker must be in the "off" position before installing.

CB03

This model is our single breaker lockout for circuit breakers that do not have a recess hole.

1 To install, the breaker must be in the "off" position. Place the breaker lockout over the switch.

2 Insert your screwdriver (star type) into the hole, tighten the screws well.

3 Insert your lock or tag and close. Make sure everything is tight.

4 Lock in place using a padlock

This model will accommodate circuit breakers with an overall width of 12mm (1/2").

Remember, the breaker must be in the "off" position before installing

CB02

Our double pole breaker lockout requires that there be two switches connected together with a cross bar.

1 to install, place over the switches with the slotted side of the lockout covering the switches.

2 Pull the slide bar out to attach padlock.

This model will accommodate breakers with an overall width of 45mm (1.3/4").

Remember, the breaker must be in the "off" position before installing.

CB04

Our double pole breaker lockout requires that there be two switches connected together with a cross bar.

1 Pull the slider bar and place between the breaker lockout over the breakers.

2 Push back the slider bar and put your padlock over the breakers.

This model will accommodate double or triple breakers.

Remember, the breaker must be in the "off" position before installing

TECHNICAL DATA SHEET No. 26B

Reece Safety Products Ltd

Unit B9, Lowfields Close, Lowfields Business Park, Elland, West Yorkshire HX5 9DX

Tel: 01422 310456 Fax: 01422 311070 Email sales@reecesafety.co.uk www.reecesafety.co.uk



Product Information and Assembly Instructions - Intermediate Circuit Breaker Lockout Kit ECBKIT (Sheet 2)

CB05

Locates prongs from inside



- Push button operated, the model CB05 fits most popular breakers up to 60 Amp. Will also fit multi-pole breakers.
- 1 Push the button to release the prongs
 - 2 Hold in position and place the two prongs into the two locating holes either side of the circuit breaker switch.
 - 3 Lock in place using a padlock

Remember, the breaker must be in the "off" position before installing

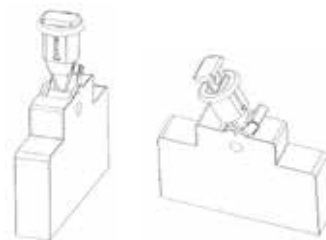

CB06

Locates prongs from outside



- Push Button operated, the model CB06 fits most popular breakers up to 60 Amp. Will also fit multi-pole breakers.
- 1 Push the button to release the prongs
 - 2 Hold in position and place the two prongs into the two locating holes either side of the circuit breaker switch.
 - 3 Lock in place using a padlock

Remember, the breaker must be in the "off" position before installing

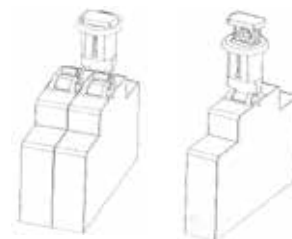

CB07

Locates prongs from inside



- Push button operated, the model CB07 fits most popular breakers up to 60 Amp. Will also fit multi-pole breakers.
- 1 Push the button to release the prongs
 - 2 Hold in position and place the two prongs into the two locating holes either side of the circuit breaker switch.
 - 3 Lock in place using a padlock

Remember, the breaker must be in the "off" position before installing.

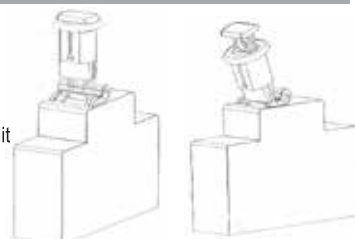

CB08



- Adjustable thumb wheel operation, model CB08 fits larger or multi-pole circuit breakers connected with a cross bar. No holes in the breakers are required.
- 1 Unscrew the thumb wheel anti clockwise to release the clamp
 - 2 Place the lockout over the breaker as shown and tighten the thumb wheel as required.
 - 3 Lock in place using a padlock

Remember, the breaker must be in the "off" position before installing.

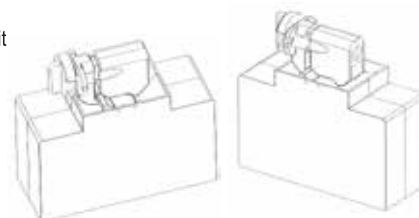

CB09

Thumb wheel operation, model CB09 "No hole" circuit breaker ideal for breakers without built in locking facility.

- 1 Place circuit breaker in the OFF position (figure 1)
- 2 Place the lockout component over the circuit breaker switch tongue as shown (figure 2). Rotate thumb wheel anti-clockwise to release the locking clamp if necessary
- 3 Rotate thumbwheel clockwise to secure the lockout device to the circuit breaker switch tongue (Figure 3)
- 4 Flip the cover over the lockout, blocking access to the thumb wheel (Figure 4)
- 5 Verify that the circuit breaker tongue switch is securely fastened and cannot be switched on
- 6 Lock in position with a padlock or lockout hasp and attach safety tag as required (Figure 5)

Remember, the breaker must be in the "off" position before installing.

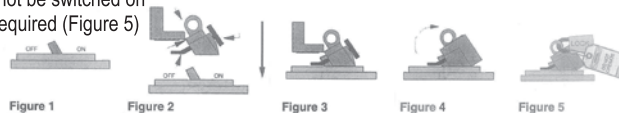

CB12 / UCL1

The CB12/UCL1 can be used to lock breakers which have no locking facilities.



- 1 Place circuit breaker in the OFF position (figure 1)
- 2 Place the CB12/UCL1 over the circuit breaker toggle as shown (figure 2).
- 3 Using a small screwdriver, tighten the internal grub screw securing the CB12/UCL1 onto the toggle (figure 3).
- 4 Place a lockout padlock through the hole as shown (figure 4).
- 5 Verify that the circuit breaker toggle is securely fastened and cannot be switched on (figure 5).



CB16

- 1 Switch the breaker to the off position and place the CB16 over the switch as shown. Using the toggle, tighten the screw clamping the CB16 onto the switch.
- 2 Rotate the toggle as shown
- 3 Place a padlock through the locking hole preventing the toggle from operating

